

Calvin Hazeran 140 Tv Unit

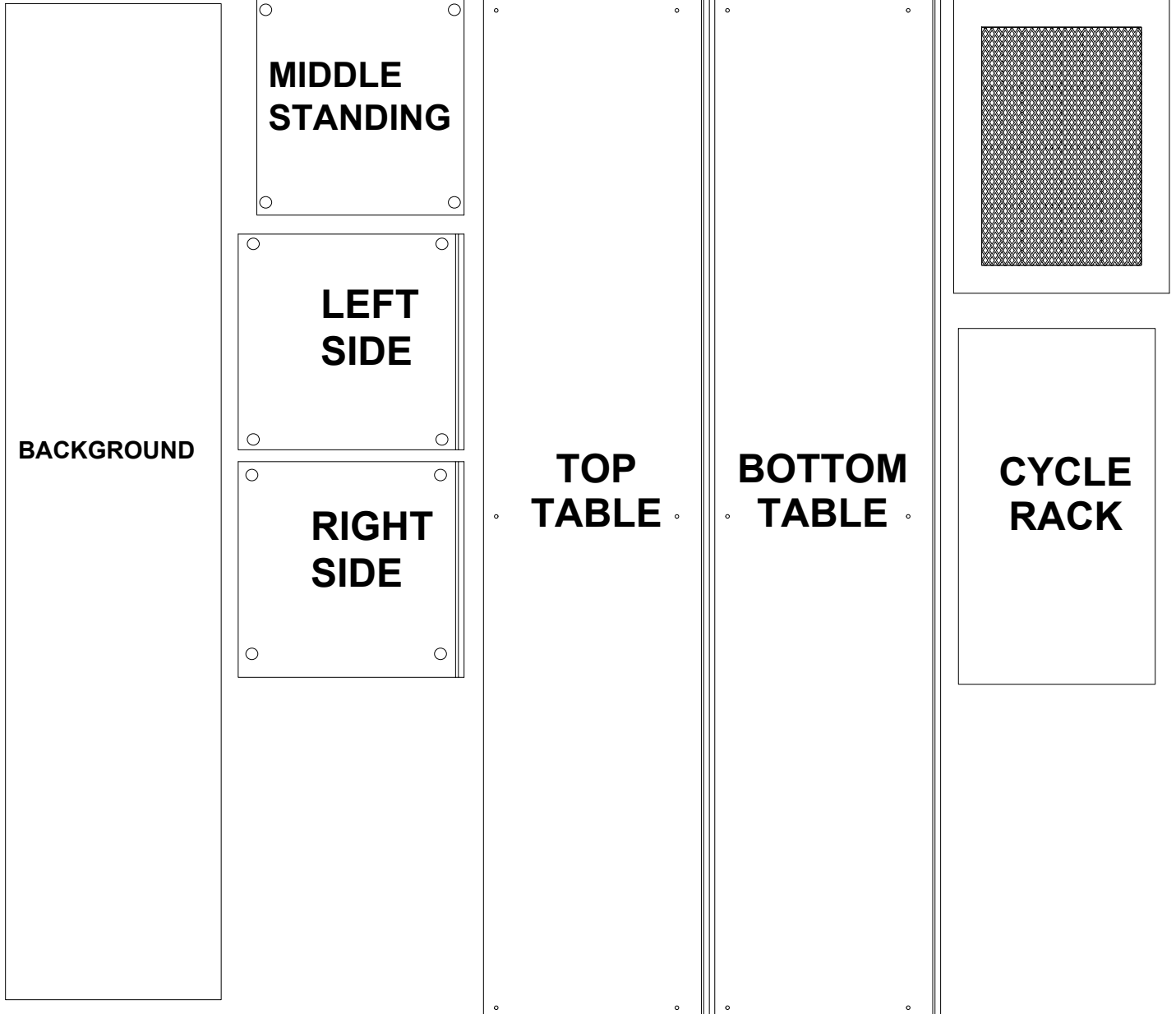

ACCESSORY LIST

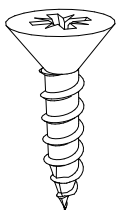

**3,5x18
SCREW**

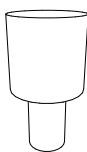

SHELF PIN

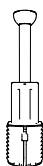

**MINIFIX
SHAFT**

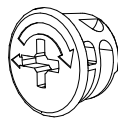

**MINIFIX
OMON**

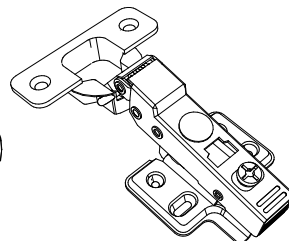

**FULL
CAMEL
HINGE**

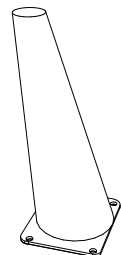

WOOD LEG

1

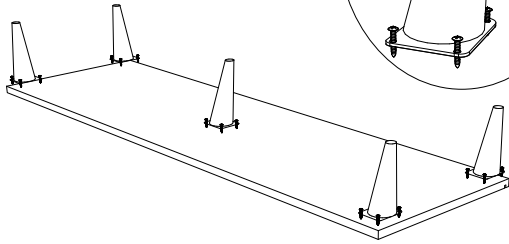
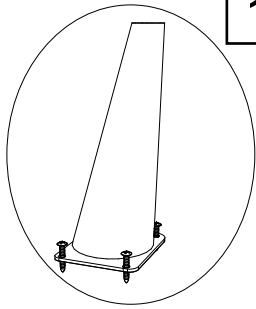
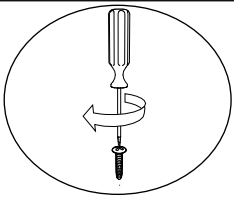

Feet on guide marks as in the image
Mount it.



2

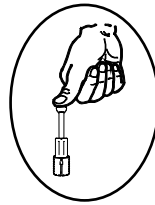

Insert and fix the minifix
shafts into the previously
prepared guide holes.

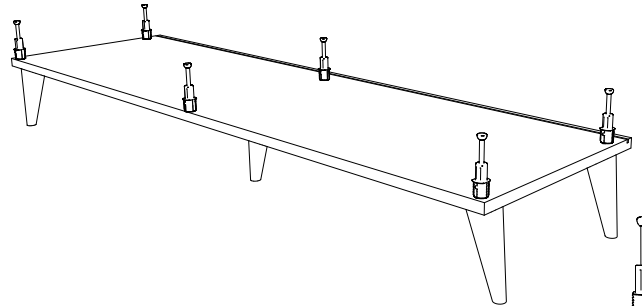

6 Quantity

3

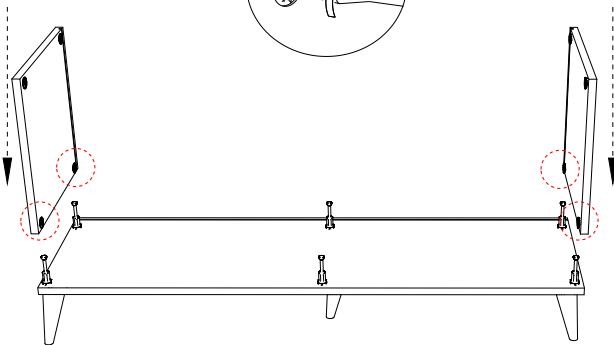
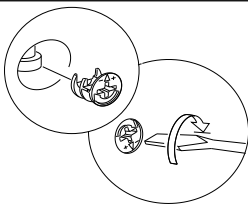

Place the right side
and left side on the
minifix shafts and
secure by tightening
the minifix nut.



4 Quantity

4

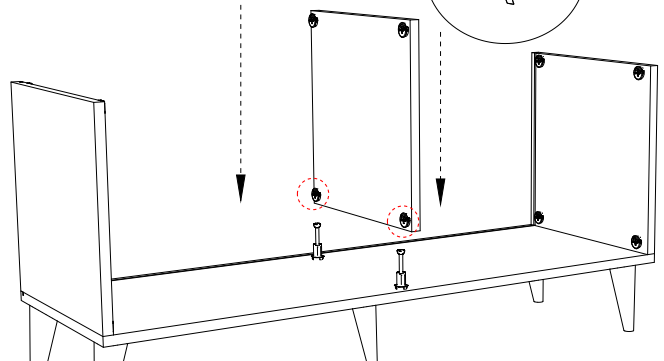
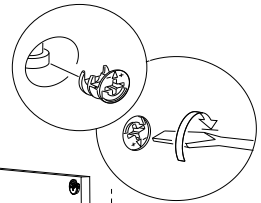

Center strut
place the minifix on the minifix
shafts
and fix it by squeezing.



2 Quantity

5

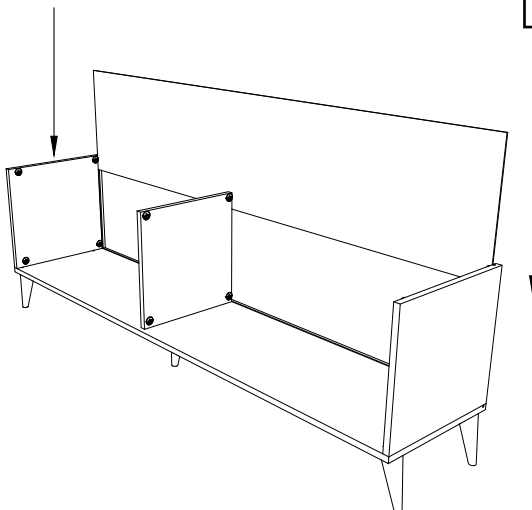

Place the backrest between the channels.

6

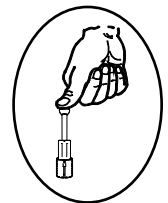
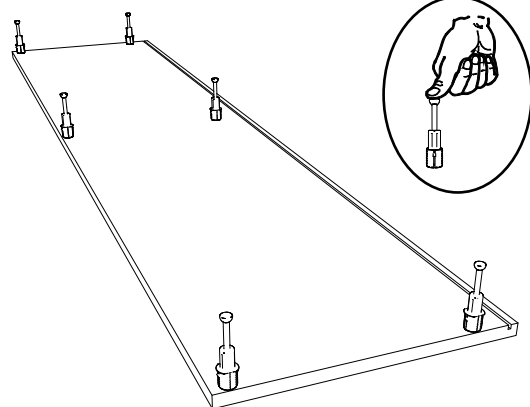

Insert the minifix shafts
into the guide holes on
the upper table and fix
them.

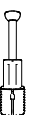

6 Quantity

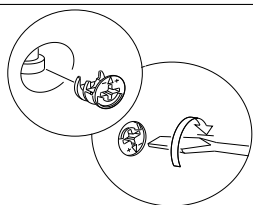

Place the top plate on the minifix shafts and secure it by tightening the minifix nut.



6 Quantity

Before placing the mobile shelf
Mount the shelf pins on the slots as
shown in the image.

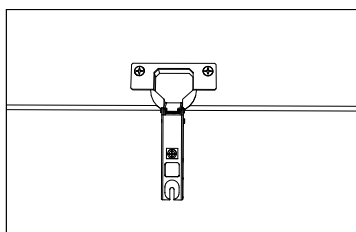
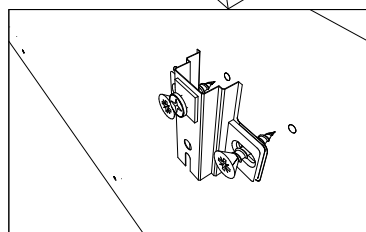
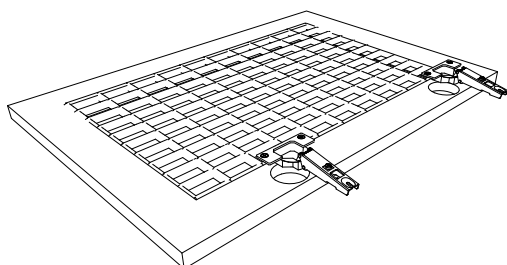
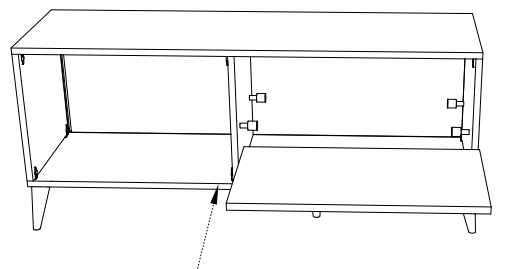

Mount the hinge strikes on the tracks as shown in the image.

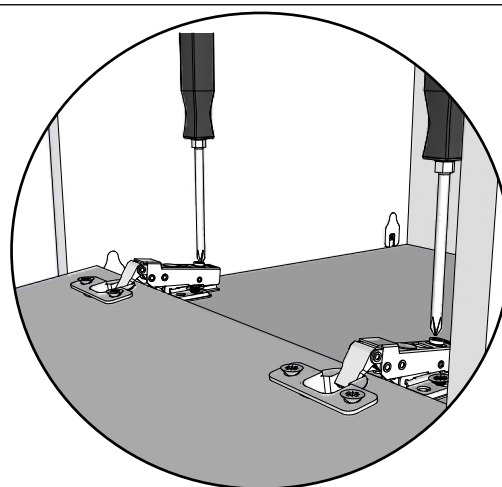

Place and secure the hinges as shown in the image.

You can adjust the asymmetrical stance between the lids by loosening the screw, positioning it in the desired position and then tightening it.

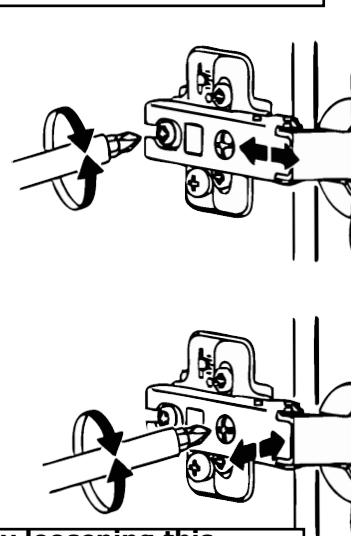
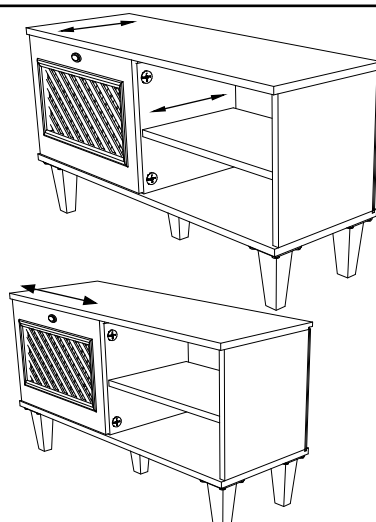

The distance between the lids can be adjusted by loosening this screw, positioning it in the desired position and then tightening it.

If you are satisfied with our service, you can honor us with your positive ratings and comments and contribute to other customers to shop with us. you can be found.