

Calvin Buffet

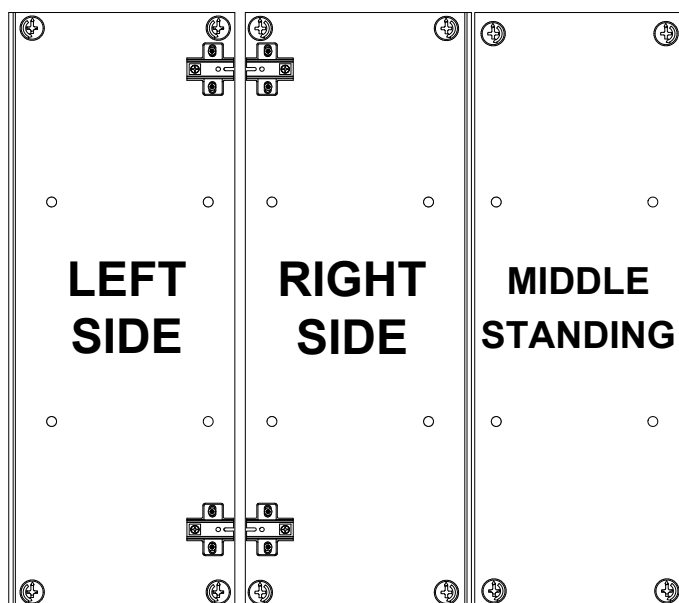

ACCESSORY LIST

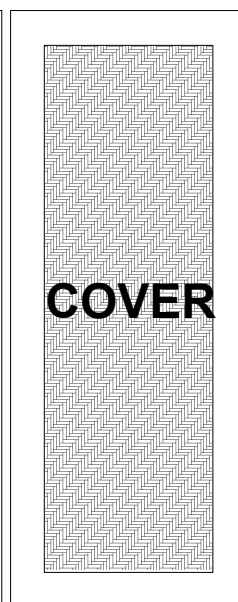
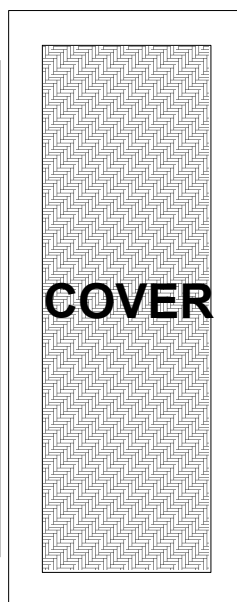
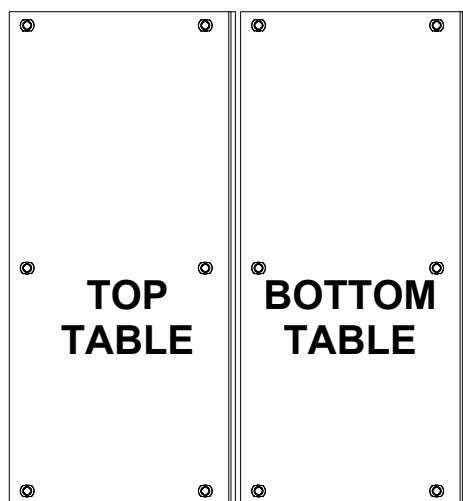
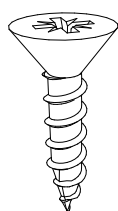

3,5x18 SCREW

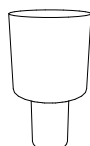

SHELF PIN

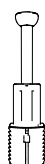

MINIFIX SHAFT



MINIFIX NUT

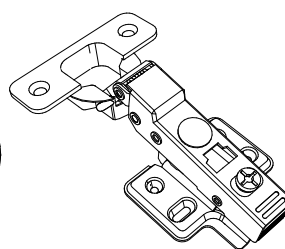

FULL CAMEL HINGE

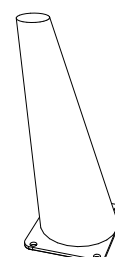

WOOD LEG

1

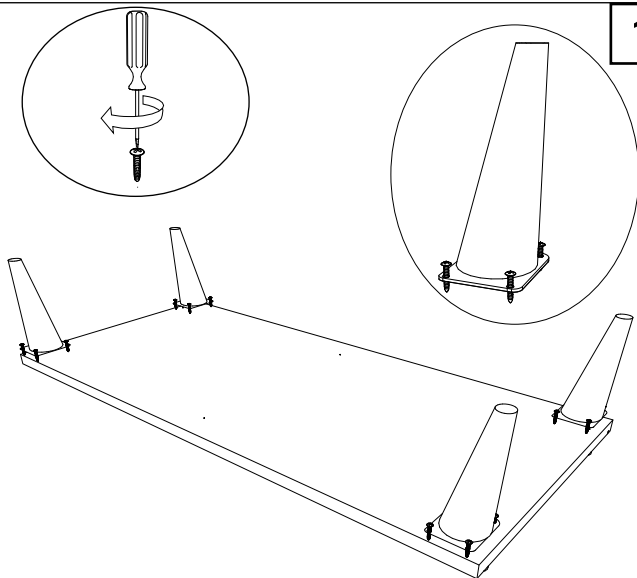

Feet on guide marks as in the image
Mount it.

2

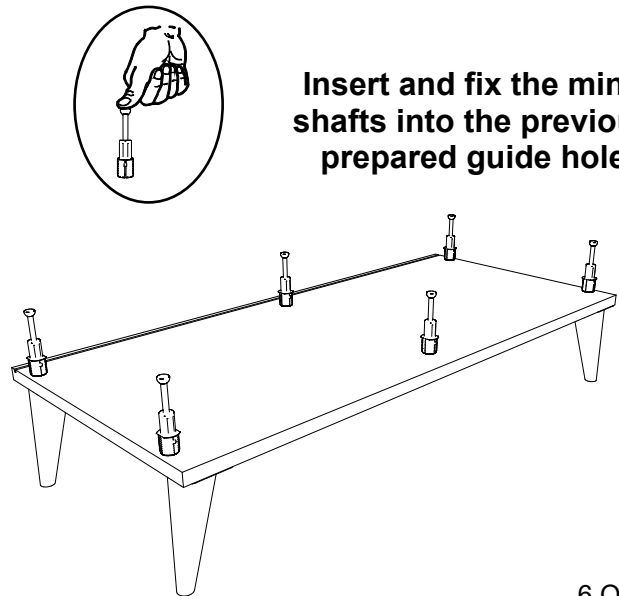

Insert and fix the minifix
shafts into the previously
prepared guide holes.

6 Quantity

3

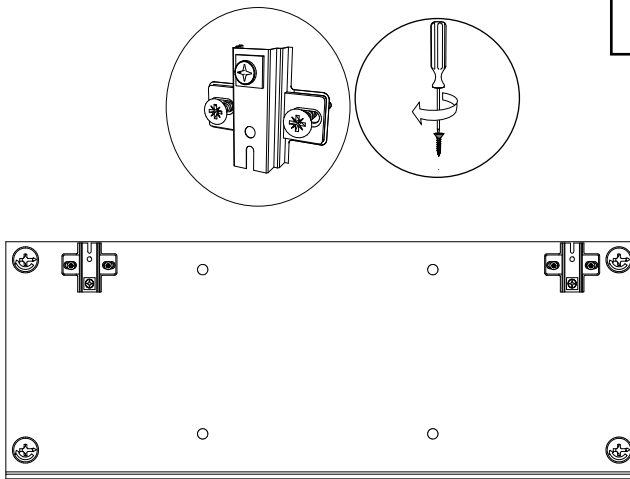

Fix the hinges on the guide marks
prepared for the hinges.

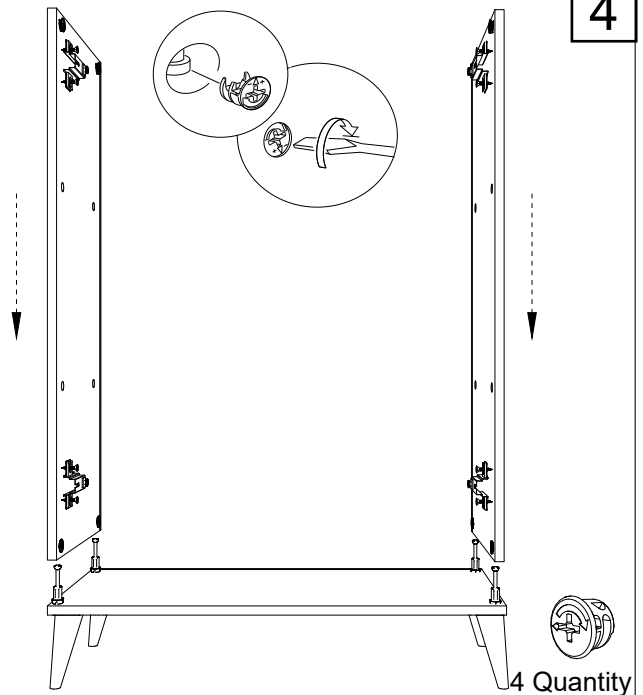

V1

4

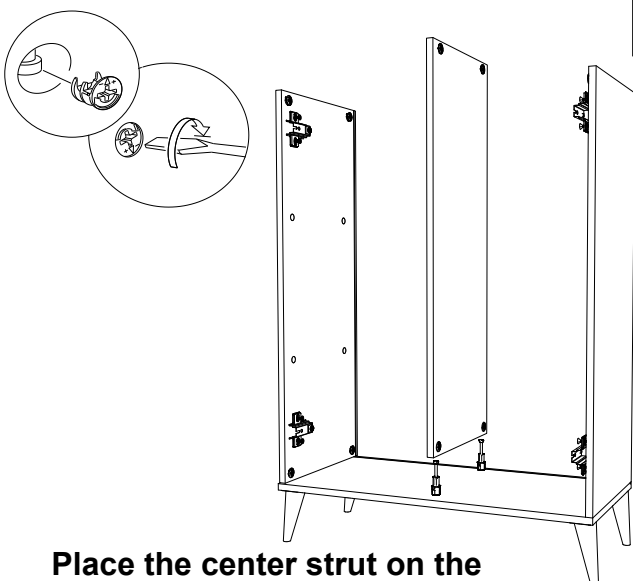

4 Quantity

5



Place the center strut on the
minifix shafts
Secure by tightening the minifix
nut.

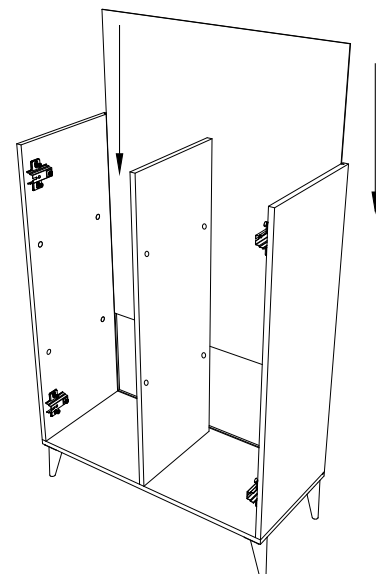

2 Quantity

6

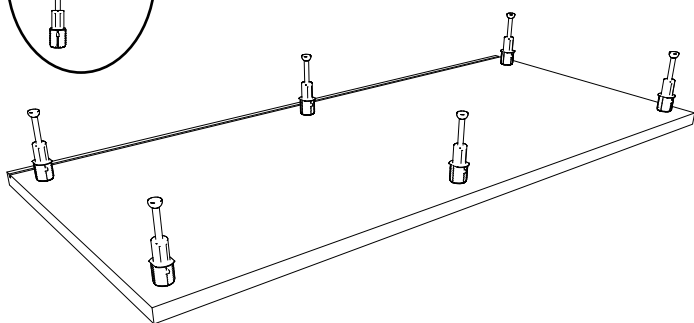
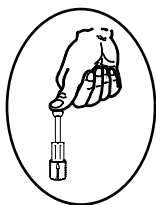

Place the backrest between the channels.

7



Insert the minifix shafts into the guide holes on the upper table and fix them.

8

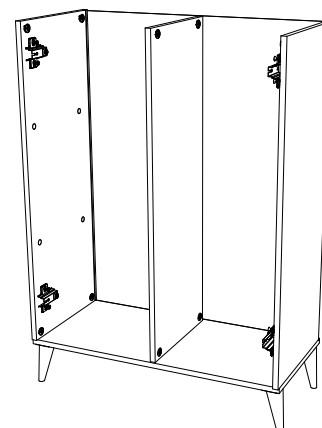
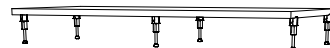
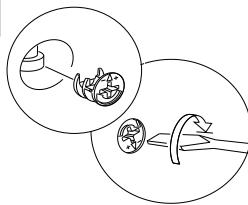

4 Quantity

Place the top plate on the minifix shafts and secure it by tightening the minifix nut.

9

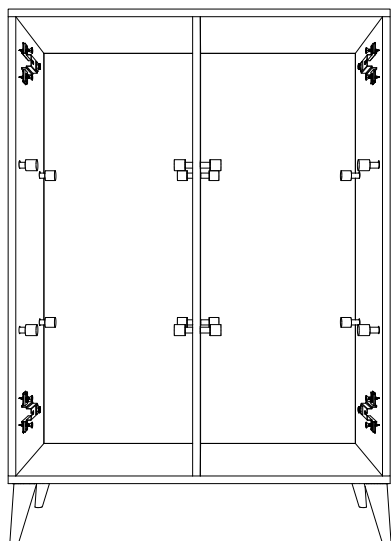

Before placing the mobile shelf
Mount the shelf pins on the slots as shown in the image.



V5

10

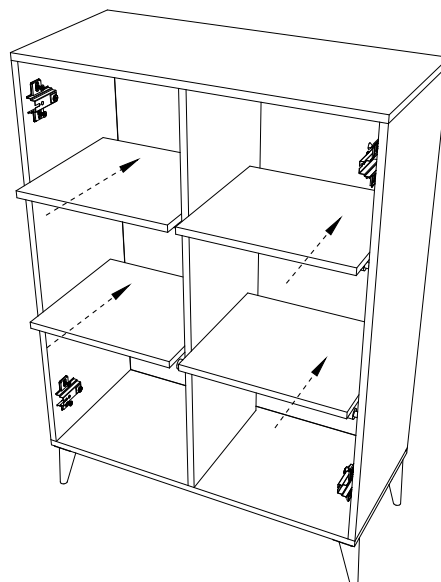

Place the mobile shelves as shown in the visual.

4 Quantity

11

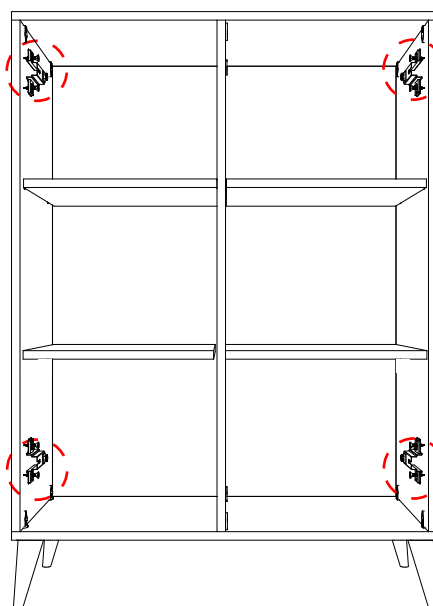
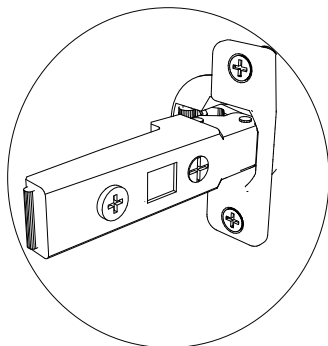

To the covers marked in the image
Full camel hinge is used.

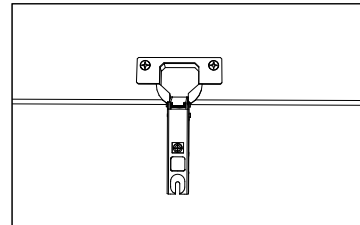
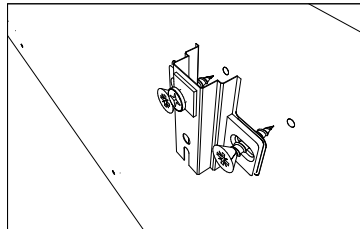
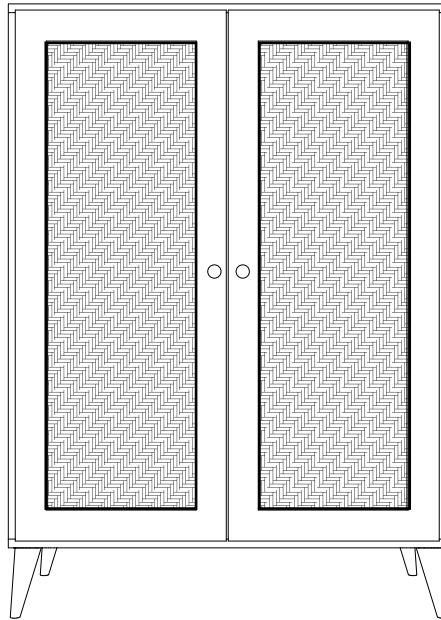

Mount the hinge strikes on the tracks as shown in the image.

You can adjust the asymmetrical stance between the lids by loosening the screw, positioning it in the desired position and then tightening it.

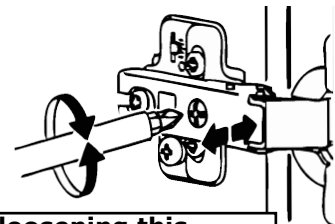
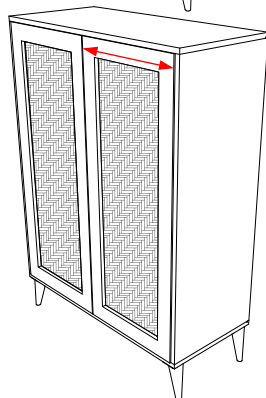
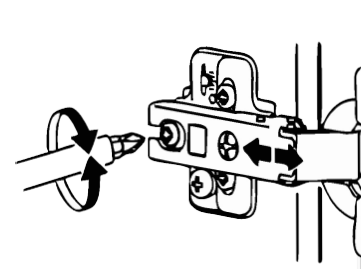
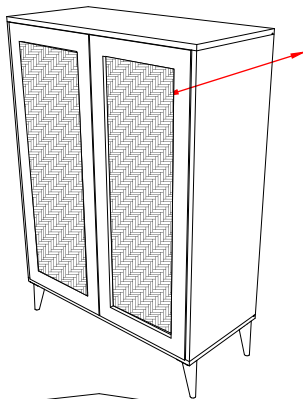

The distance between the lids can be adjusted by loosening this screw, positioning it in the desired position and then tightening it.

If you are satisfied with our service, you can honor us with your positive ratings and comments and contribute to other customers to shop with us. you can be found.