

# DYNAMIC 05

## 7 RAFLI DOLAP DAR MODÜL

### KURULUM ŞEMASI

#### ASSEMBLY GUIDE



MODÜL BİRLEŞTİRME DETAYI  
(MODULE FIXING DETAIL)

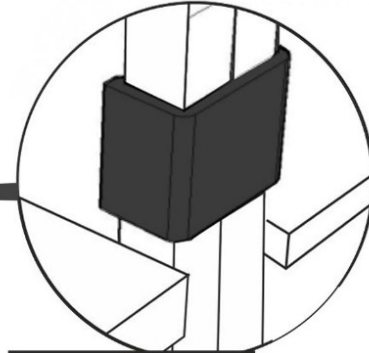

MODÜL BİRLEŞTİRME APARATI  
(PLASTIC MODULE FIXING) x4

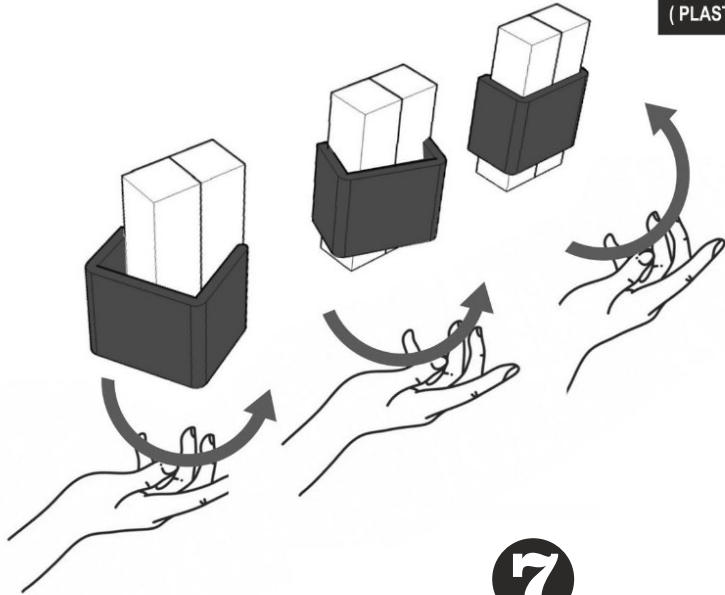

7



1

\* AKSESUARLARI GÖSTERİLDİĞİ GİBİ DÜZ BİR ZEMİN ÜZERİNDE TAKINIZ...  
 \* ÜRÜNÜ KURARKEN MONTAJ SIRASINI TAKİP EDİNİZ  
 \* FİX THE ACCESORIES AS SHOWN FOLLOW THE  
 INSTALLATION SEQUENCE WHILE INSTALLING THE PRODUCT.

	<b>DÜBEL x 28 (PEG)</b>		<b>ÇEKTİRME VIDASI x 28 (PULLING SCREW)</b>		<b>MODÜL BİRLEŞTİRME APARATI x 4 (BLACK PLASTIC)</b>
	<b>KABİN VIDASI x 14 (CABINET SCREW)</b>		<b>3,5 X 18 SUNTA VIDASI X14 (3.5X18 SCREW)</b>		<b>AYAK KEÇESİ x 4 (FOOT SEAL)</b>

## AKSESUAR LİSTESİ / ACCESSORY LIST

Bu modül iki kişi tarafından kurulmalıdır.  
 This unit should be assembled by two persons.

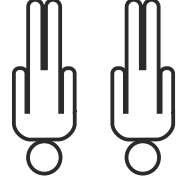

9

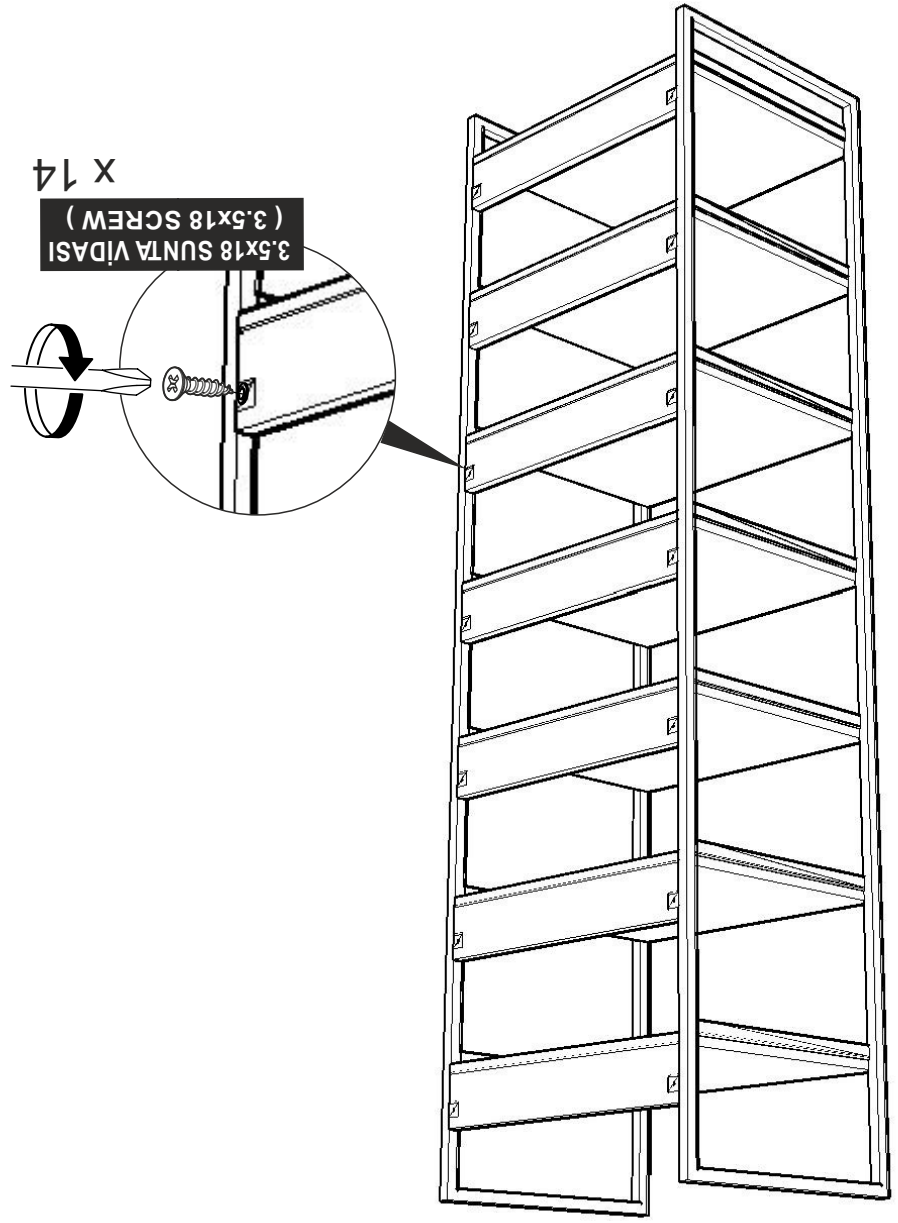

3.5X18 SUNTA VIDASI  
(3.5X18 SCREW)

X 14

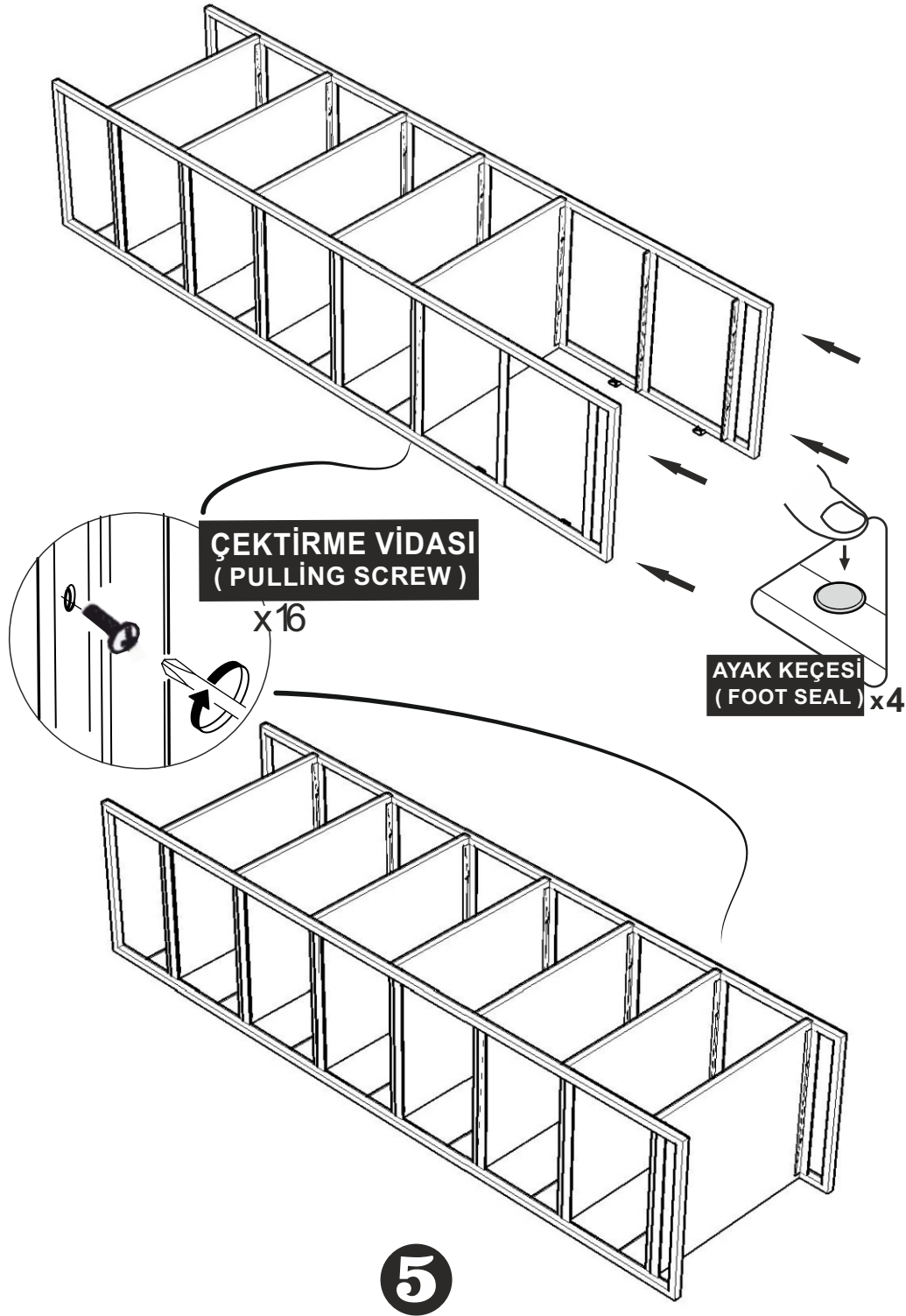

## DİKKAT !! / ATTENTION !!

Dübel ve Çektirme vidası ürünlerimizde kullanılan ana bağlantı malzemesidir.

Montaja başlamadan önce lütfen aşağıdaki çizimleri kontrol ederek, anlamaya çalışın...

Peg and Pulling Screw is the main connection material used in products. Before starting assembly, please check the drawings below...

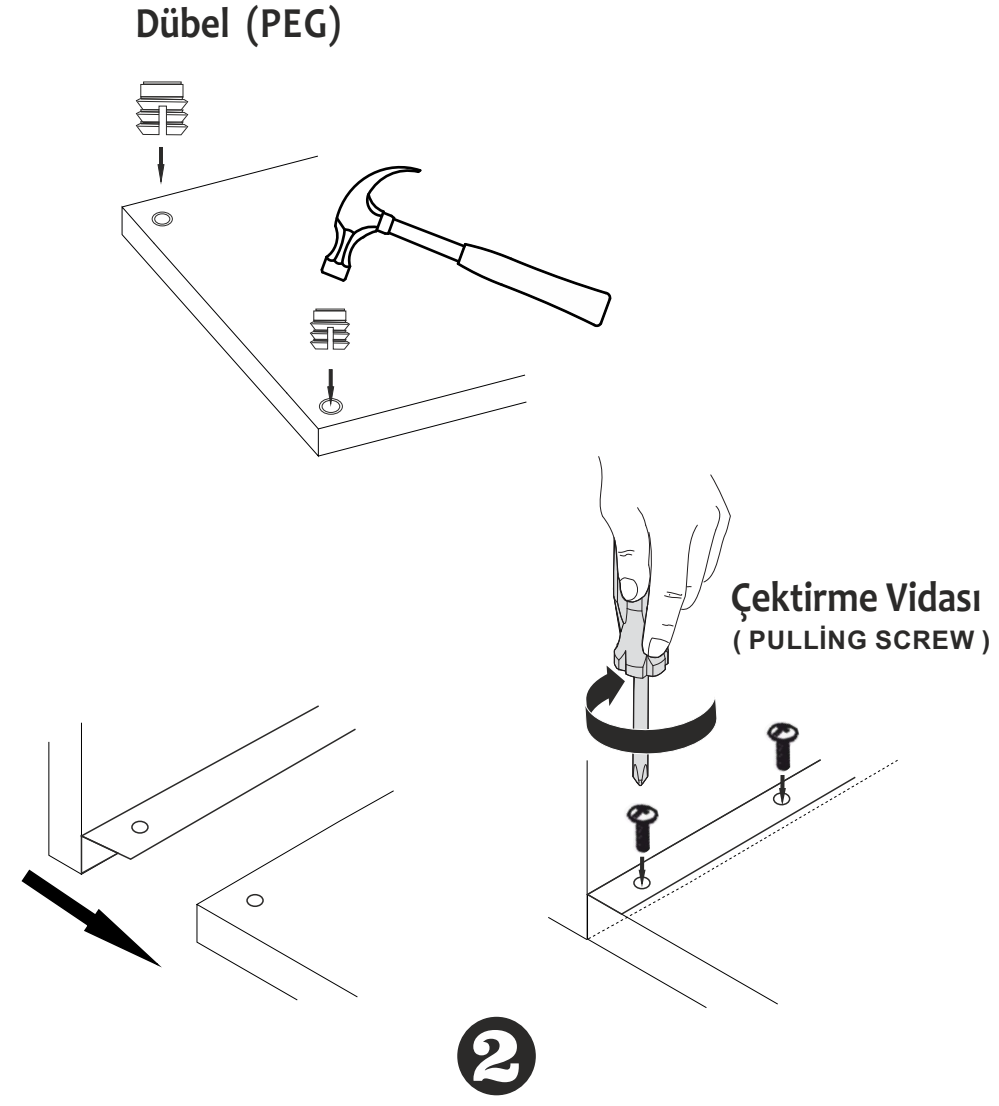

4

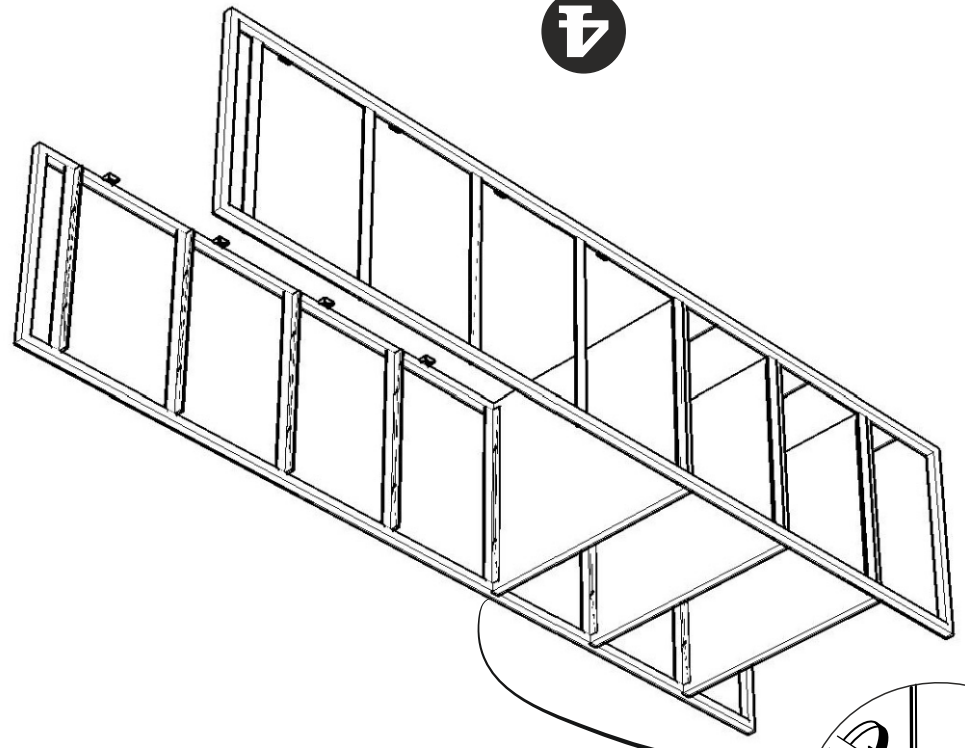

ÇEKİRME VIDASI  
(PULLING SCREW)  
X8

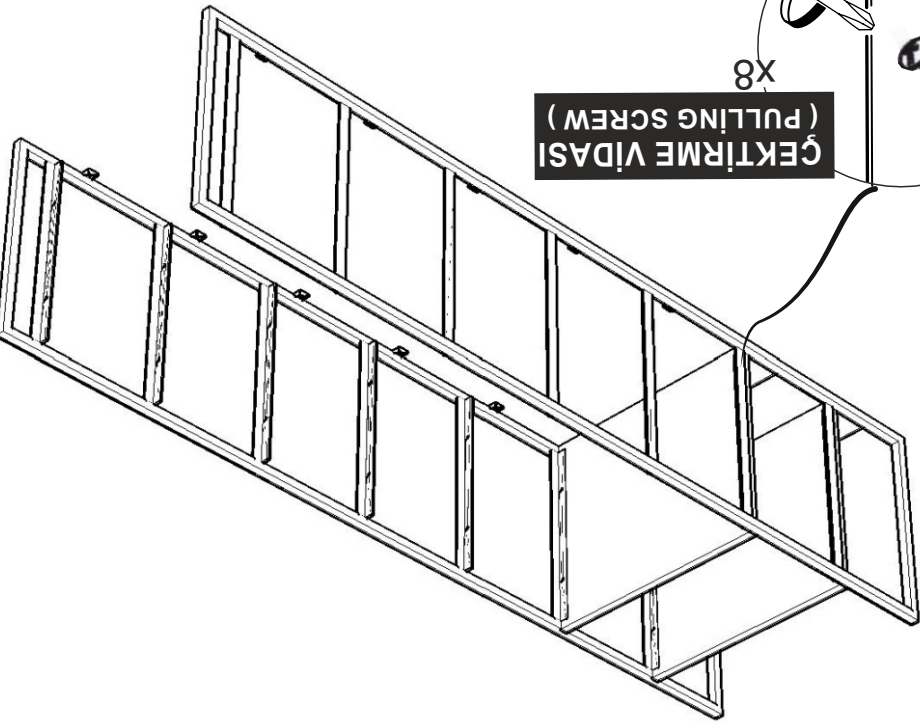

3

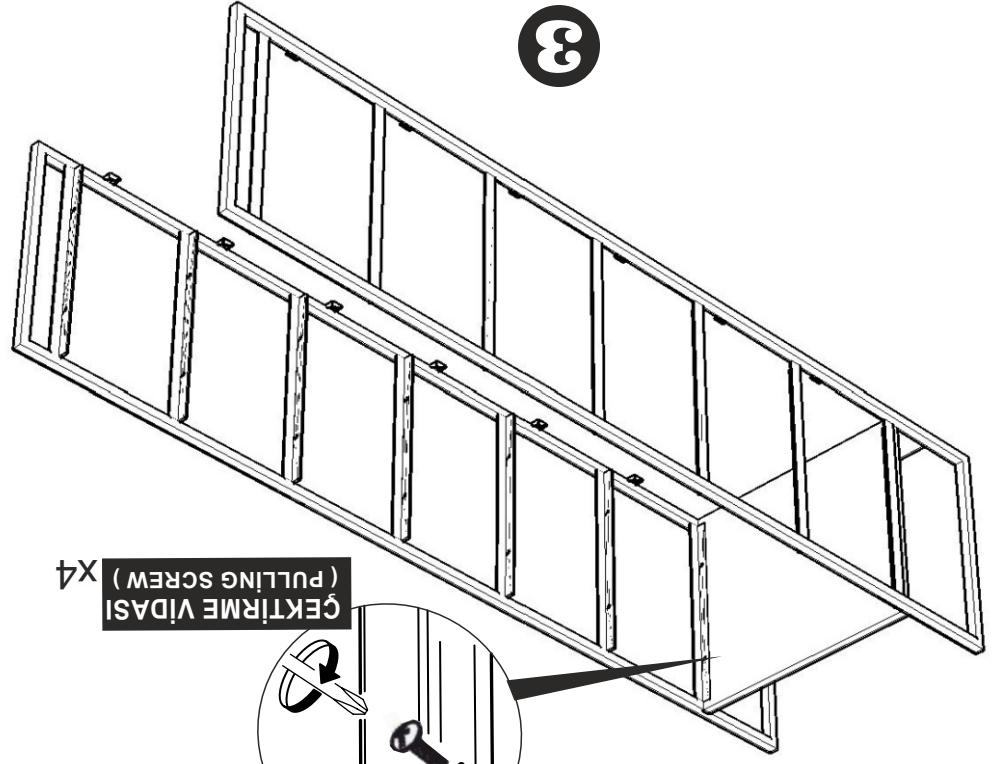

ÇEKİRME VIDASI  
(PULLING SCREW)  
X4

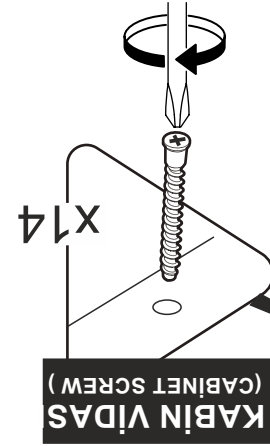

KABİN VIDAS  
(CABINET SCREW)  
X14

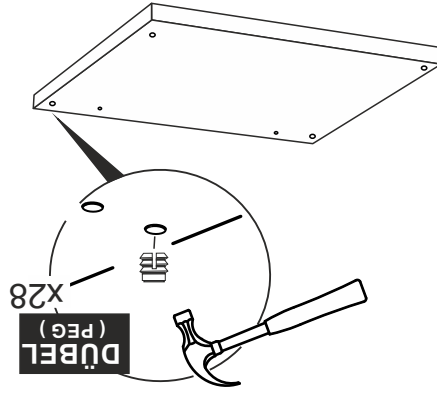

DÜBEL  
(PEG)  
X28