

Ambalaj içeriği:

- | | |
|---|----------|
| 1 Wooden table (bottom) | 1 Piece |
| 2 wooden pole | 1 Piece |
| 3 centering pin | 2 Pieces |
| 4 dowel | 2 Pieces |
| 5 Lampshade head (De-mounted) | 1 Piece |
| 5-1 Subframe (Disassembled) | 2 Pieces |
| 5-2 Upper frame (Disassembled) | 2 Pieces |
| 5-3 Lampshade head cover (De-assembled) | 1 Piece |
| 6 Wooden tray (top) | 1 Piece |
| 7 socket nut | 1 Piece |
| 8 holder and raising bar | 1 Piece |
| 9 lock bolt | 2 Pieces |
| 10 locking nut | 2 Pieces |
| 11 elevation nut | 1 Piece |
| 12 socket adapter | 1 Piece |
| 13 lamp post | 1 Piece |
| 14 plastic feet | 4 Pieces |

1

Assembly Instruction;

- 1) Please confirm with the number and content information of the parts coming out of the product packaging.
- 2) Place the dowels numbered "4" on the part numbered "1" and "6". (May require light force)

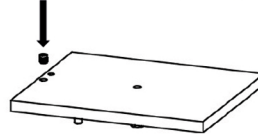

- 3) Fix the locking bolt numbered "11" with the help of screwdriver and drill to the fixed parts numbered "4".

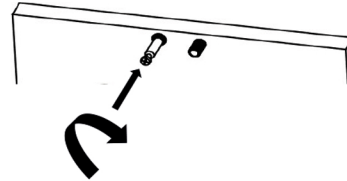

- 4) Place the parts numbered "3" in the appropriate places on the part numbered "2". (No force required)

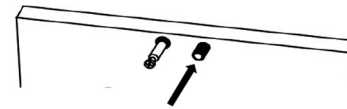

2

- 5) Passing the "8" part through the "12" part and the "12" part through the hole in the "6" part. Fix it with piece 13.

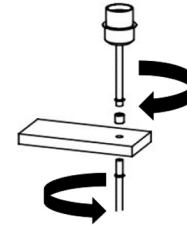

- 6) Assemble the assembled upper group "6" to the lower part "1" and "2". Place the nut numbered "11" on the screw part at the bottom with the help of a wrench clockwise.

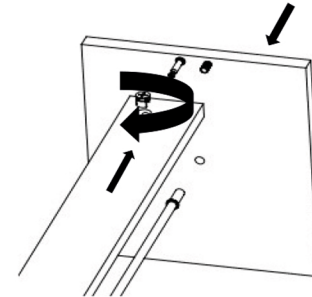

- 7) Insert the piece numbered "8" into the hole in the center of the piece numbered 6 with the socket facing up.

3

- 8) Let's assemble the lampshade cap according to the following explanation.

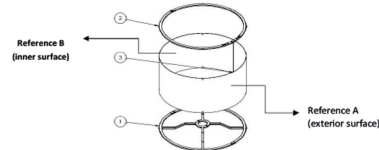

With the "Reference A" surface of part "5-3" facing outwards, combine as in the pictures.

Figure A



After bringing the piece "5-3" to the stage in "Figure A", the ring made of the cap is locked with the internal locking mechanism.

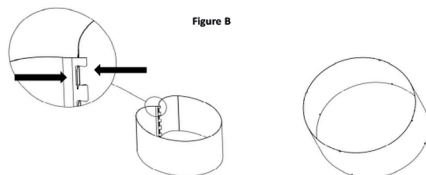
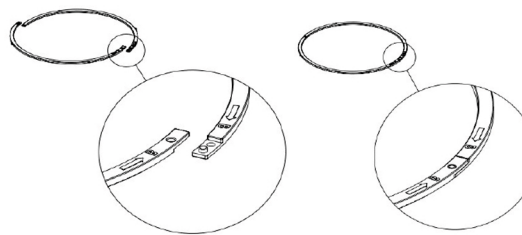

Figure B

4

The part "5-2" is locked from the double-sided locking mechanism as in "Figure C".

Figure C



The part "5-3" is locked from the double-sided locking mechanism as in "Figure D".

Figure D

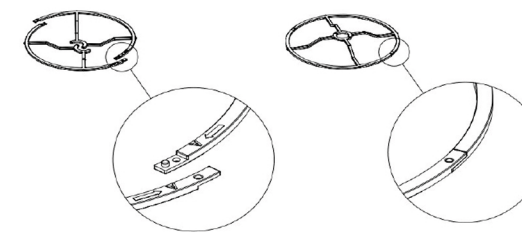

5

The assembled "5-2" and "5-1" parts are mounted through the "5-3" holes.

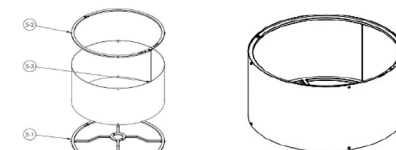

After the "5" part is mounted to the "8" part, the "7" part is mounted by screwing the "8" part.

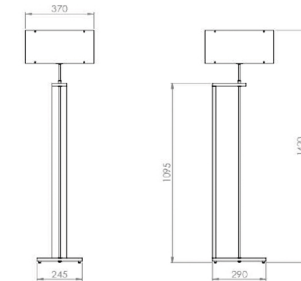

- 9) Insert the bulb and fix the plug to the 220 V socket inlet and prepare it for use.
- 10) To illuminate, turn the switch on the cable to the "ON" position.

6

